

KAAST Hydraulic 4-roll bending machine

RBD-4HD

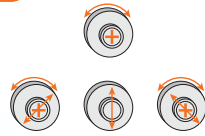

Standard configuration

- Overload protection
 - Hydraulic top and side rolls (3 pcs.)
 - Digital readout for top and side rolls
 - Hydraulic closure for easy removal of bent parts
 - Welded, heavy steel frame
 - Induction hardened
- rolls made of SAE 1050 (CK 45) steel
 - Conical bending device
 - Automatic lubrication
 - Electronic/mechanical balancing device
 - 2 bending speeds
 - Operation manual

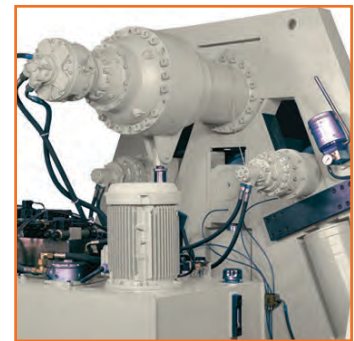
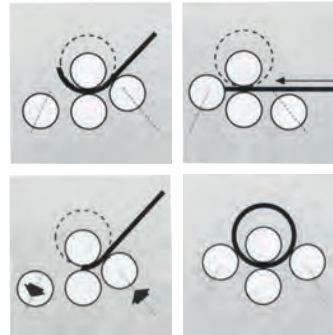

- For medium and heavy bending tasks
- The frame is of solid welded construction
- All rollers have high-quality, heavy-duty ball bearings, which ensures minimum friction and even rotation of the bending rollers
- Hydraulic roller is driven by independent

- drive motors and planetary gearboxes
- Because the planet gears are mounted directly on the rollers, the transmission of force takes place without loss of force or power
- The simultaneous use of torsion bars and hydraulic units ensure maximum machine accuracy and production flexibility

Specifications		RBD-4HD									
		2050/20	2050/25	2050/30	2550/16	2550/20	2550/25	2550/30	2550/45	3100/12	3100/16
		6' x 0.75"	6' x 1"	6' x 1.15"	8' x 0.6"	8' x 0.75"	8' x 1"	8' x 1.15"	8' x 1.75"	10' x 0.45"	10' x 0.6"
Bending length	mm	2050 (80")			2550 (100")					3100 (120")	
Bending capacity*	mm	20 (0.75")	25 (1")	30 (1.15")	16 (0.6")	20 (0.75")	25 (1")	30 (1.15")	45 (1.75")	12 (0.45")	16 (0.6")
Pre-bending capacity*	mm	16 (0.6")	20 (0.75")	25 (1")	12 (0.45")	16 (0.6")	20 (0.75")	25 (1")	35 (1.35")	10 (0.4")	12 (0.45")
Top & bottom rolls	mm	Ø280 (11")	Ø320 (12.5")	Ø350 (13.5")	Ø280 (11")	Ø320 (12.5")	Ø350 (13.5")	Ø380 (14.5")	Ø460 (18")	Ø280 (11")	Ø320 (12.5")
Side rolls	mm	Ø220 (8.5")	Ø240 (9.5")	Ø260 (10")	Ø220 (8.5")	Ø240 (9.5")	Ø260 (10")	Ø300 (11.5")	Ø380 (14.5")	Ø220 (8.5")	Ø240 (9.5")
Main motor	kW	16.5 (21 Hp)	20 (27 Hp)	23.5 (32 Hp)	16.5 (21 Hp)	20 (27 Hp)	23.5 (32Hp)	31.5 (43 Hp)	38.5 (50 Hp)	16.5 (21 Hp)	20 (27 Hp)
Weight	kg	8550 (18,810 lbs)	10500 (23,100 lbs)	11500 (25,300 lbs)	9650 (21,230 lbs)	11600 (25,520 lbs)	12800 (28,160 lbs)	16700 (36,740 lbs)	22400 (49,280 lbs)	10600 (23,320 lbs)	12750 (28,050 lbs)
Item No.		9412140	9412141	9412142	9412143	9412144	9412145	9412146	9412147	9412148	9412149

Specifications		RBD-4HD									
		3100/20	3100/25	3100/30	3100/45	3100/60	4100/8	4100/12	4100/16	4100/20	4100/40
		10' x 0.75"	10' x 1"	10' x 1.15"	10' x 1.75"	10' x 2.35"	13' x 0.3"	13' x 0.45"	13' x 0.6"	13' x 0.75"	13' x 1.5"
Bending length	mm	3100 (120")					4100 (160")				
Bending capacity*	mm	20 (0.75")	25 (1")	30 (1.15")	45 (1.75")	60 (2.35")	8 (0.3")	12 (0.45")	16 (0.6")	20 (0.75")	40 (1.5")
Pre-bending capacity*	mm	16 (0.6")	20 (0.75")	25 (1")	35 (1.3")	45 (1.75")	6 (0.25")	10 (0.4")	12 (0.45")	16 (0.6")	30 (1.15")
Top & bottom rolls	mm	Ø350 (13.5")	Ø380 (14.5")	Ø400 (15.5")	Ø500 (19.5")	Ø580 (22.5")	Ø280 (11")	Ø350 (13.5")	Ø380 (14.5")	Ø400 (15.5")	Ø550 (21")
Side rolls	mm	Ø260 (10")	Ø300 (11.5")		Ø400 (15.5")	Ø480 (19")	Ø220 (8.5")	Ø260 (10")	Ø300 (11.5")		Ø450 (17.5")
Main motor	kW	23.5 (32 Hp)	31.5 (43 Hp)	38.5 (50 Hp)	60 (82 Hp)	73 (100 Hp)	16.5 (21 Hp)	23.5 (32 Hp)	31.5 (43 Hp)	38.5 (50 Hp)	66 (90 Hp)
Weight	kg	14450 (31,790 lbs)	19200 (42,240 lbs)	22000 (48,400 lbs)	38500 (84,700 lbs)	50000 (110,000 lbs)	13000 (28,600 lbs)	19000 (41,800 lbs)	22000 (48,400 lbs)	23500 (51,700 lbs)	54000 (118,800 lbs)
Item No.		9412150	9412151	9412152	9412153	9412154	9412155	9412156	9412157	9412158	9412159

*The above specifications are subject to change without prior notice. No liability for printing mistakes. Machine may be shown with optional equipment.

** Bending capacities are given for 24 kg/mm² yielding strength, minimum dia. top roll x 5 (For cone, bending capacities needs to be reduced. Call for details.)